

# POWER OUTPUT

Prime Rating — 180 kW (225 kVA)  
 Standby Rating — 200 kW (250 kVA)  
 3-Phase, 60 Hertz, 0.8 PF

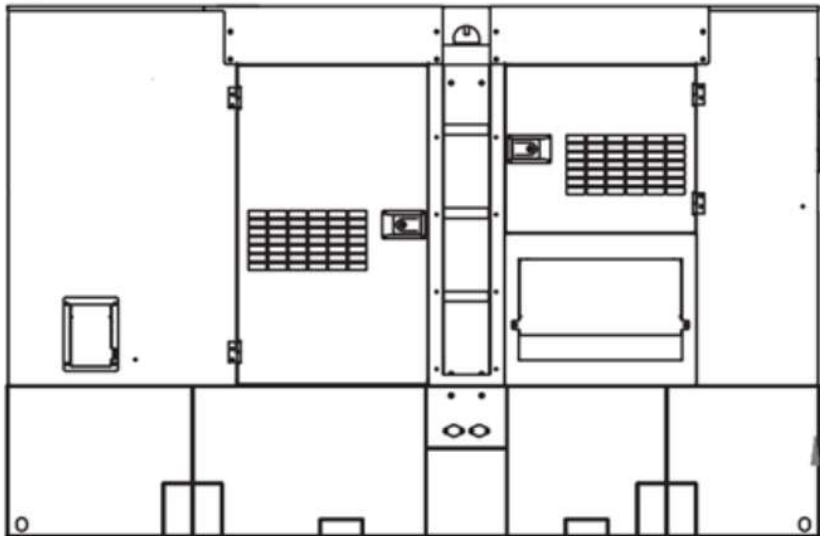

## STANDARD FEATURES

- Heavy duty, 4-cycle, variable speed fan, diesel engine provides maximum reliability.
- Brushless alternator reduces service and maintenance requirements. Class H protection.
  - Open delta alternator design provides virtually unlimited excitation for maximum motor starting capability.
  - Automatic voltage regulator (AVR) provides precise regulation.
- Electronic governor system maintains frequency to  $\pm 0.25\%$ .
- Full load acceptance of standby nameplate rating in one step
- Soundproof, weather resistant, steel housing provides operation at 72dB (A) at 7meters. Fully lockable enclosure allows safety operation. Outdoor operation available.
- Internal fuel tank with direct observing glass, and fuel level meter display on control panel  
 E-coat and powder coat paint provides durability and weather protection.
- Digital engine gauges including oil pressure, water temperature, battery volts, engine speed, and fuel level.
- Analog generator instrumentation including Ampere meter,
- Voltage meter, frequency meter, ammeter phase selector switch, voltmeter phase selector switch. Analog generator instrumentation and regulator adjustment.
- Deepsea/Comap professional generator controller.
  - High visibility LCD display with heated screen and alphanumeric readout.
  - IP65 Protection standard, operational temperature range of -40° to 85° C.
  - Modbus interface for gauge panel and expansion options.
  - DPF cleaning cycle indication.
  - Log record for inspection
- Automatic safety shutdown system monitors the water temperature, engine oil pressure, low coolant, low DEF, overspeed, and overcrank. Warning lights indicate abnormal conditions.
- Fuel/water separator. Removes condensation from fuel for extended engine life.
- Emergency stop switch — when manually activated, shuts down in any emergency.

Normal conversation allows substantially lower operating noise levels than competitive designs. UNIV Gensets are at home on construction sites, in residential neighborhoods, and at hospitals just about anywhere.

- 90 — Subway / truck traffic
- 80 — Average city traffic
- 70 — Inside car at 60 mph
- 60 — Air conditioner at 6m
- 50 — Normal conversation

**Genset at 7m**

**72.0**  
DECIBELS

## GENERATOR OUTPUT PANEL

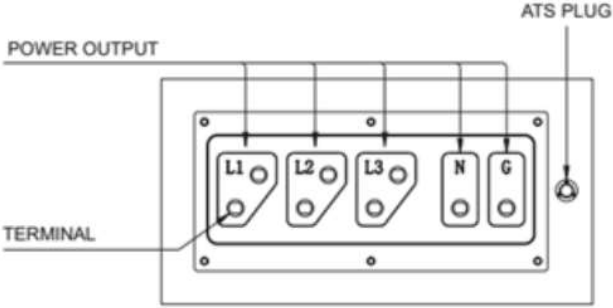

**SPECIFICATIONS**

Generator Specifications	
Armature Connection	Star with Neutral
Phase	3
Standby Output	200 KW (250 KVA)
Prime Output	180 KW (225 KVA)
Power Factor	0.8
Voltage Regulation (No load to full load)	±0.5%
Generator RPM	1800
Frequency	60 Hz
No. of Poles	4
Excitation	Brushless with AVR
Frequency Regulation: No Load to Full Load	Isochronous under varying loads from no load to 100% rated load
Frequency Regulation: Steady State	±0.25% of mean value for constant loads from no load to full load.
Insulation	Class H
Sound Level dB(A) Full load at 7M	72

Engine Specifications	
Make / Model	Perkins / 1206F-E70TTAG4
Emissions	EPA Tier4F
Starting System	Electric
Design	4-cycle, water cooled, direct injection, natural intake air cooled
Displacement	7.01 liters
No. cylinders	6
Bore x Stroke	105 x 135 mm
Gross Engine Power Output	305 hp (228 kW)
Compression Ratio	16.8 : 1
Engine Speed	1800 rpm
Overspeed Limit	2070 rpm
Oil Capacity	4.35 US gallons (16.5 liters)
Coolant Capacity	6.40 US gallons (24.25 liters)
Battery	12V 100Ah x 1

Amperage	
Rated Voltage	Maximum Amps
3Ø Volt 480/277	270.6 Amps
3Ø Volt 460/266	282.4 Amps
3Ø Volt 400/230	324.7 Amps
3Ø Volt 127/220	590.4 Amps
Main Line Circuit Breaker Rating	630 Amps
Over Current Relay Trip Set Point 220V Mode	700 Amps

Alternator	
Alternator Brand	Stamford
Alternator Model	S4L1S-C
Excitation	Brushless, Self-Excited system
Capacity(KVA)	315kva
Power(KW)	252kw
Efficiency(%)	88%
Insulation class	Class H
Protection class	Ip23
Steady state voltage regulation	±1%
Voltage control	AVR

Fuel System	
Maximum Fuel Flow (per hour)	184.9 gallons (700 liters)
Fuel Tank Capacity	230 gallons (870 liters)
Fuel Consumption	L / h
At full load	55
At 3/4 load	41
At 1/2 load	29
At 1/4 load	13.8

Control system	
Controller Brand	Deepsea
Model	DSE7320
Module	Manual/Auto start/stop module
Standard function	Engine control
	Generator monitoring
	Generator protection
	Specification
Display	Frequency
	Battery voltage
	Running hour
Warning/shutdown	under/over voltage
	under/over speed
	under/over frequency
	Low oil pressure
	High water temperature
Communication port	USB

**WARRANTY\***

**Generator**

12 months from date of purchase or 1000 hours (whichever occurs first).

**NOTICE**

Enough Air flow is extremely important to Generator operation. Improper connection can cause electrocution and/or property damage. Do not connect to any electrical system except through an approved device. Specifications are subject to change without notice.

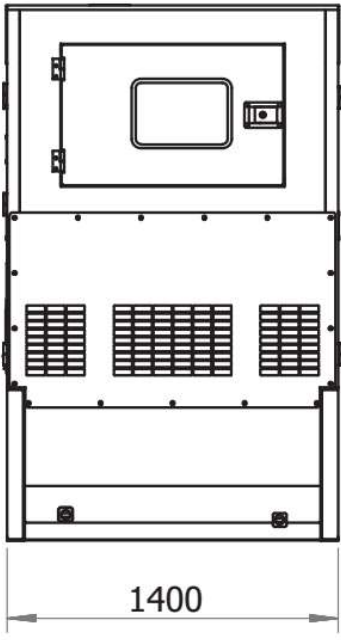
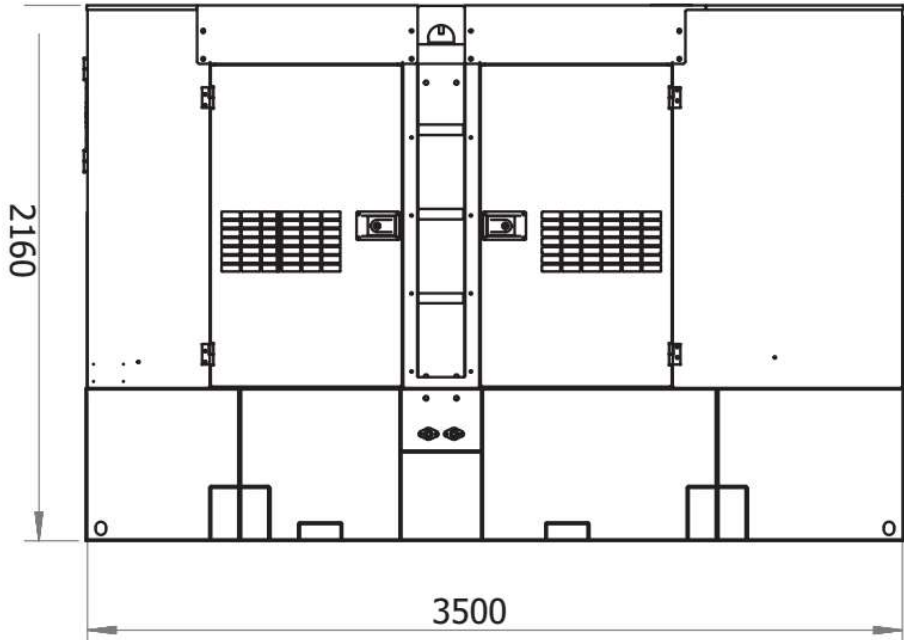

Weight	
Dry Weight	4,000 kg
Wet Weight	4,700 kg
Max. Lifting Point capacity	5,000 kg

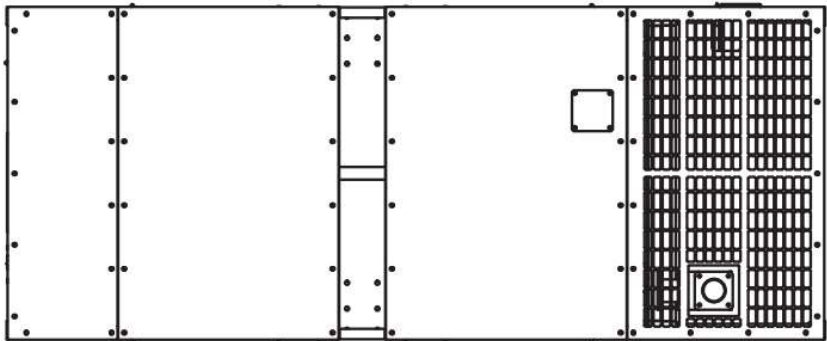

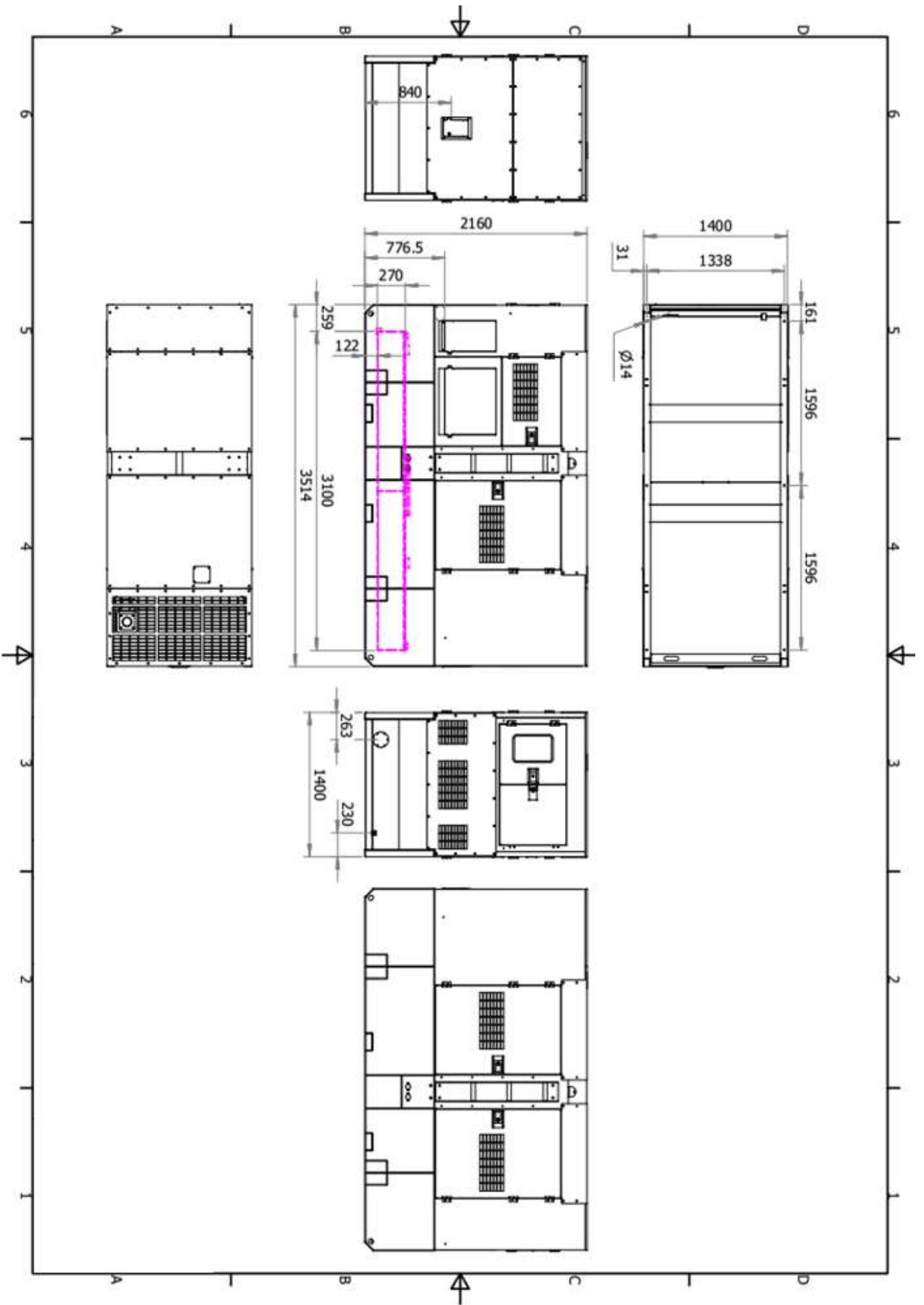

## Spill Containment

- Diesel Fuel drain and Containment drain extensions are plumbed to exterior at the rear of the generator. Actual Photo shown of drain location (with grey enclosure)



- Engine oil drain and Engine coolant drain extensions are plumbed to front exterior of the generator.

